

# Learning Spaces Collaboratory Webinar

## **Adapting Classrooms for Student-centered & Technologically-supported Pedagogies**

*March 5, 2015*

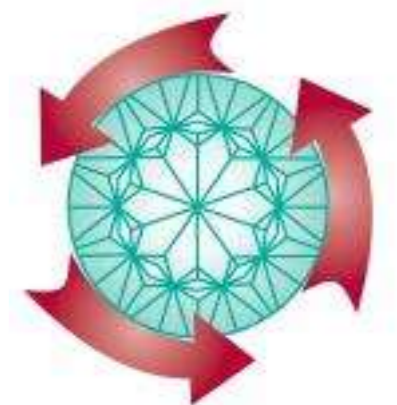

<http://www.pkallsc.org/>

The central LSC strategy is to create and catalyze a feedback loop through which the broad community of stakeholders can:

- ❖ ask and respond to questions about all aspects of planning learning spaces
- ❖ collaborate in exploring lessons learned from the community of experienced practitioners
- ❖ come to understand what is known about how the quality and nature of learning spaces affects the quality and nature of learning in the undergraduate setting.

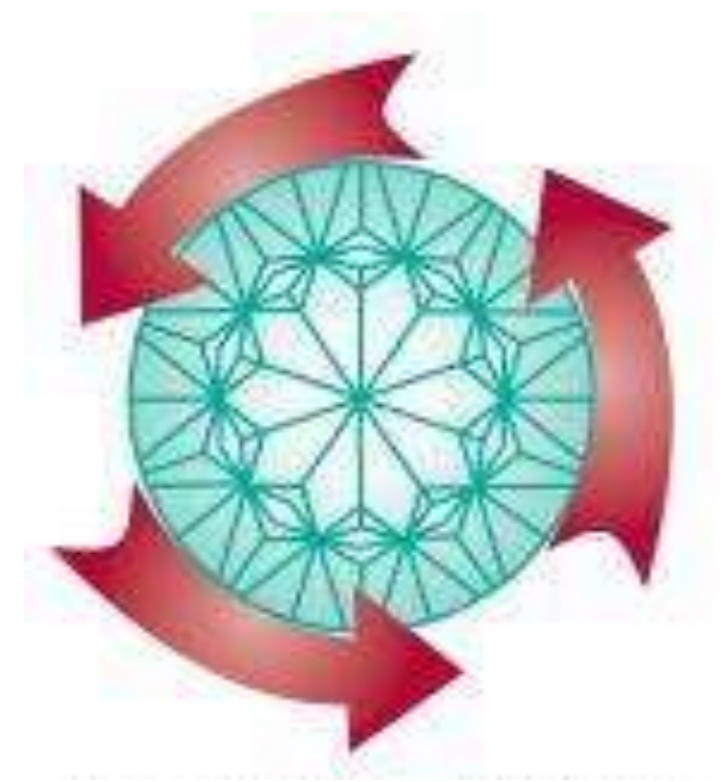

# Learning Goals

To gain a deeper understanding of:

- how to evaluate each feature of a physical space for learning for its potential impact on the quality and character of the experience of learning
- what flexibility means in the context of a space intended for active, technology-enhanced learning
- the optimal relationship between the designers and users of these learning environments.



Facilitator  
Felix Kronenberg  
Rhodes College

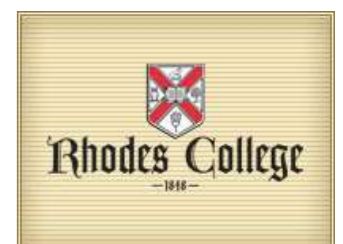



## Moderator

Bonnie Sanborn  
Cornell University











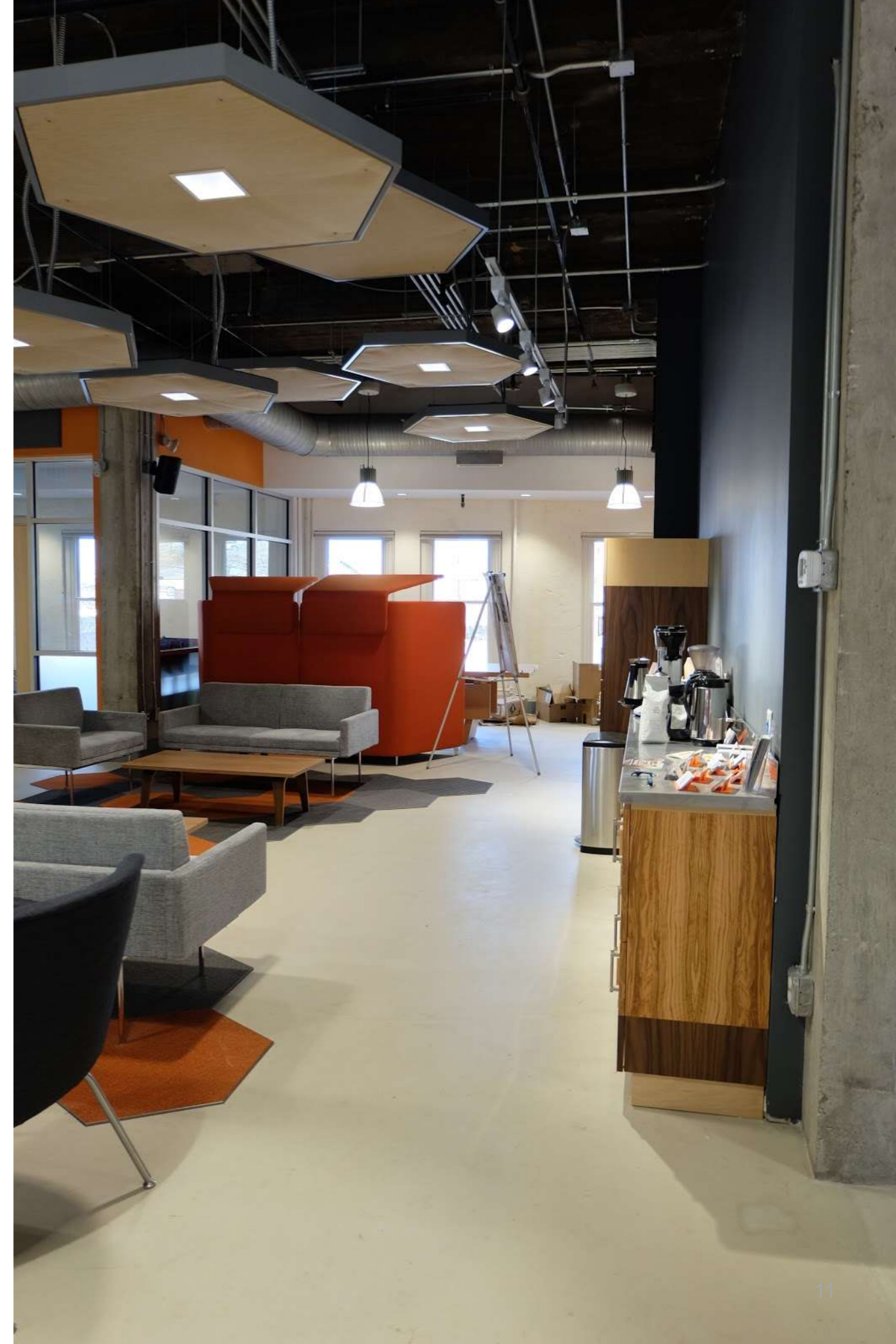



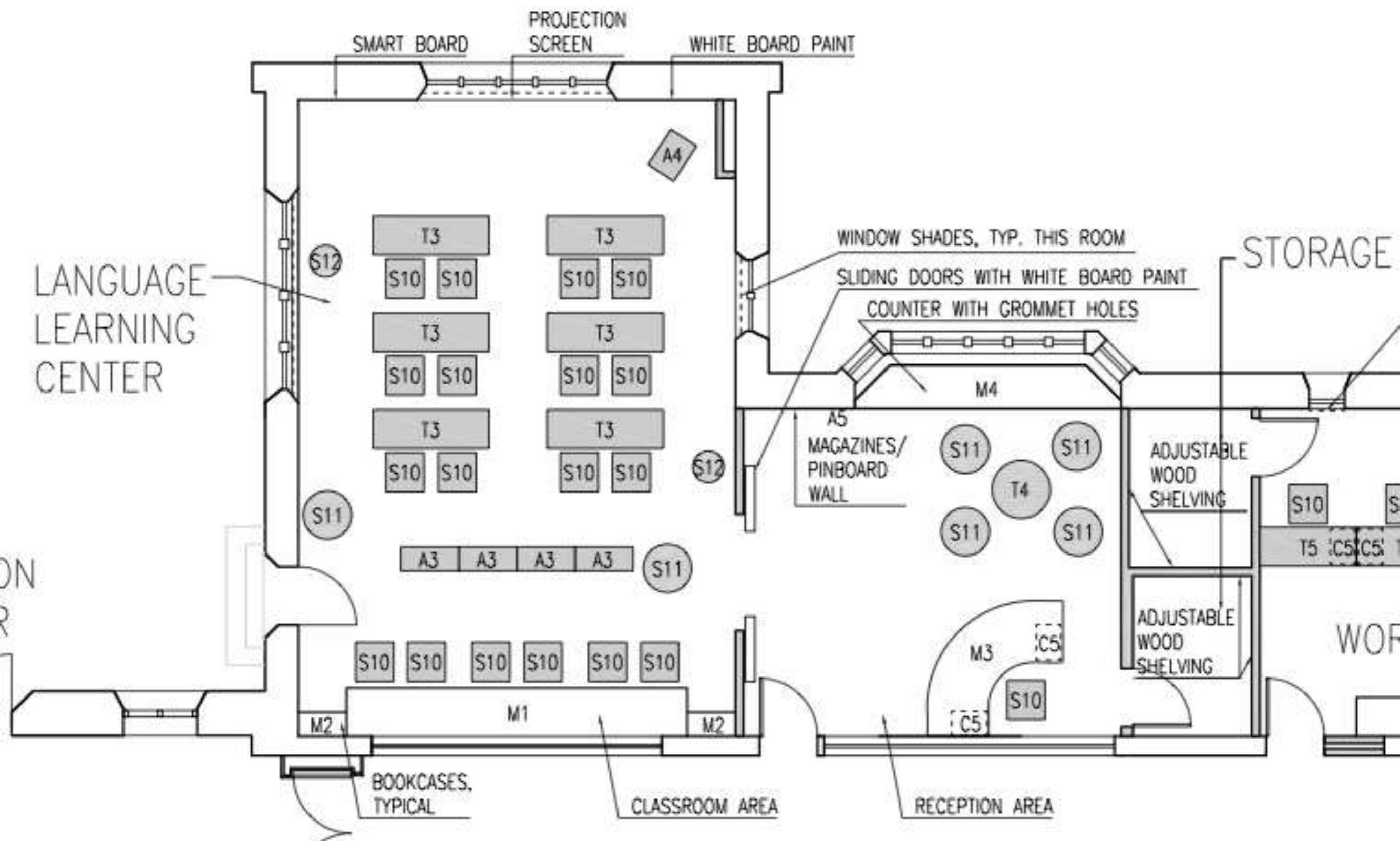

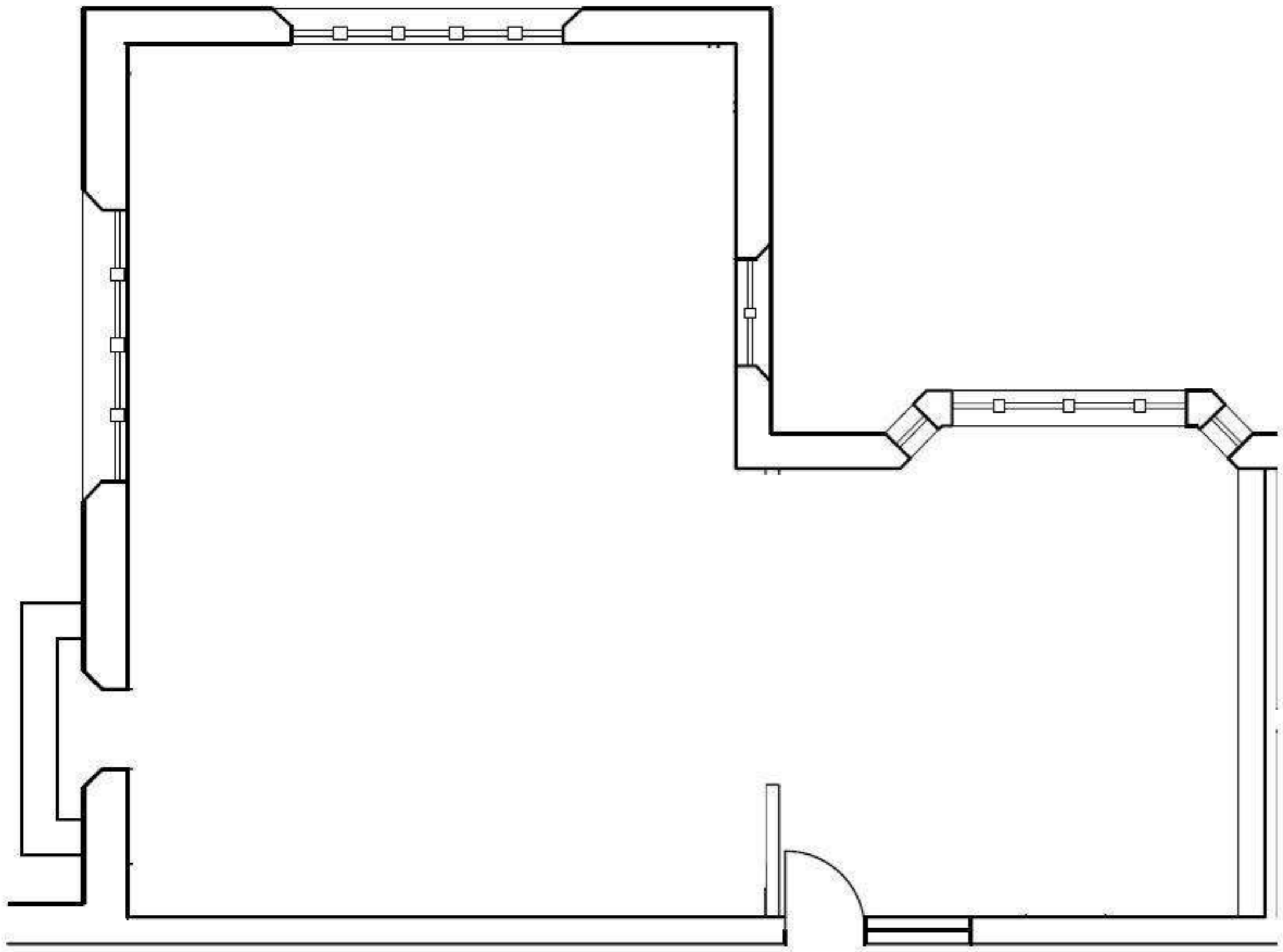























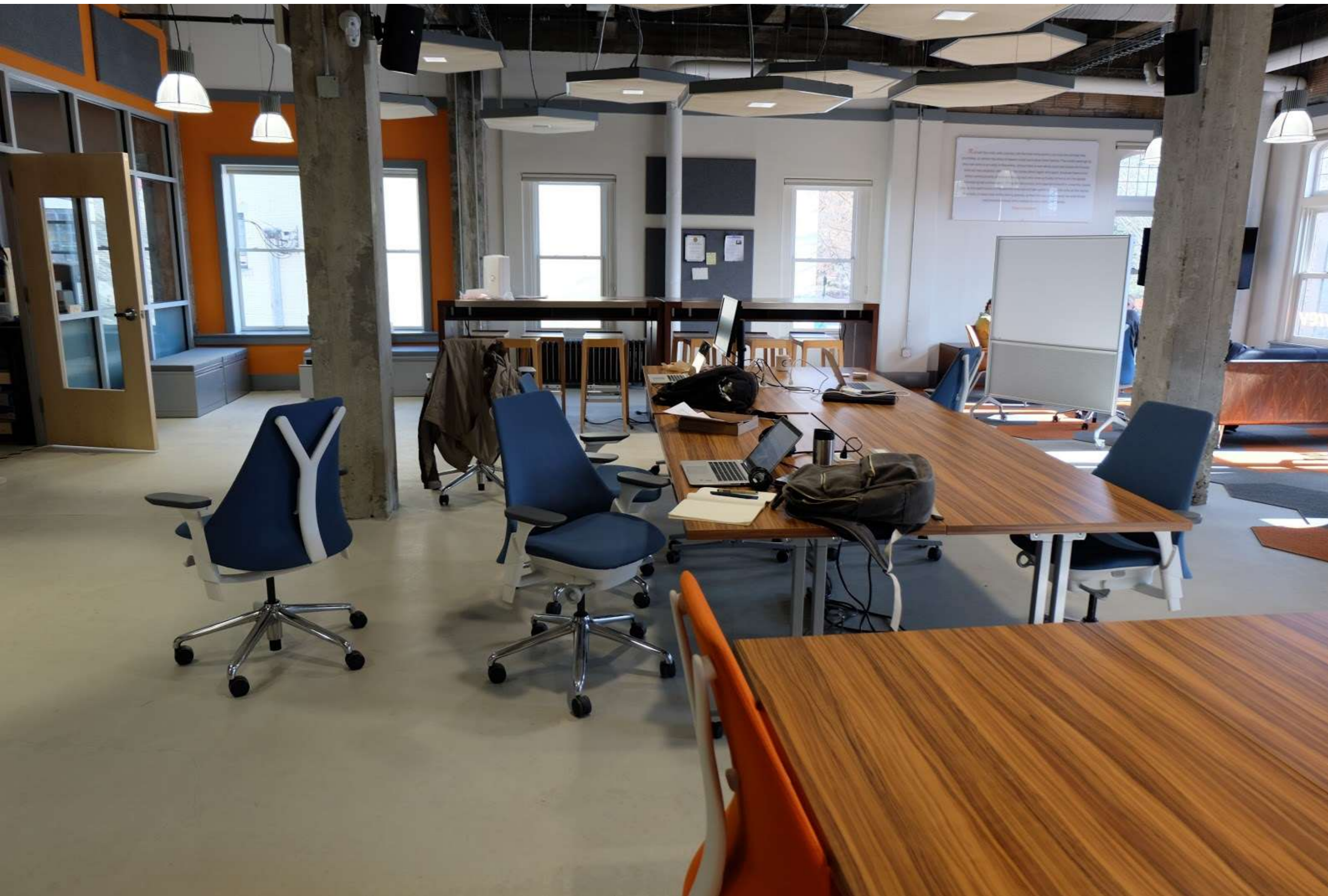

**Attn: Instructors**

**If you re-arrange the  
furniture in this room  
for your class, please  
return it to  
“CLASSROOM STYLE”  
before you leave.**

**Thank you.**

**Facility Coordinator**

By making clear that the educational space is valuable, the administration is able to demand the due respect for it from learners.

-- Freire & Freire, 1997





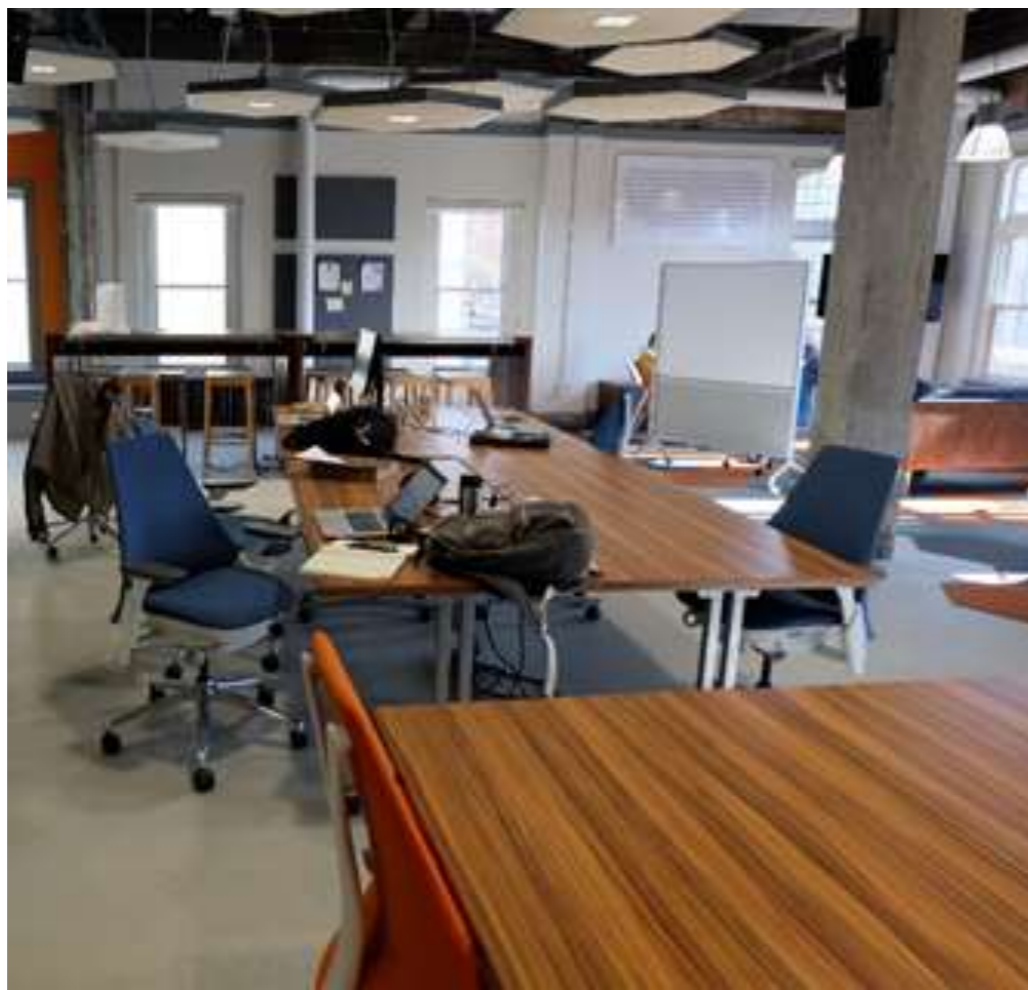
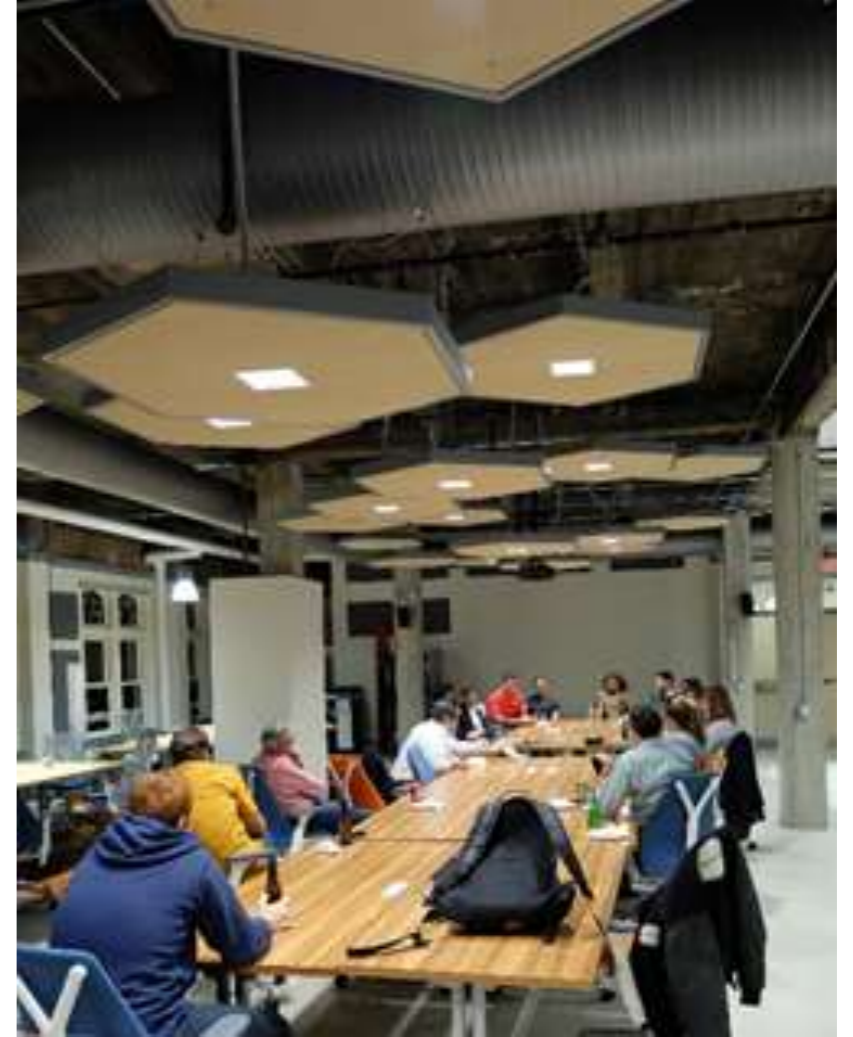







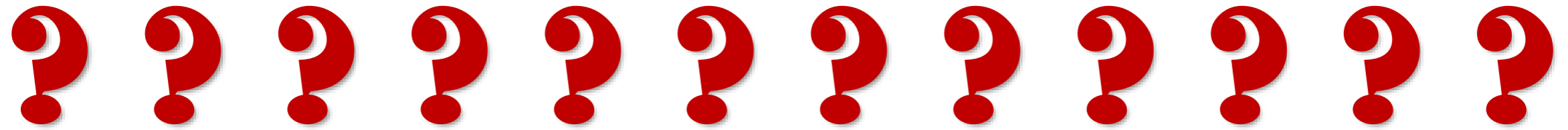

Augsburg College ♦ Bay Path University ♦ Brigham Young University ♦ Bryn Mawr College ♦ Calvert Wright Architecture, PC ♦ Calvin College ♦ Claremont Colleges Library ♦ Corning Community College ♦ Cuyahoga Community College, Westshore Campus ♦ EwingCole ♦ FKP Architects ♦ HOK ♦ Hord Coplan Macht ♦ Keene State College ♦ Lawrence University ♦ Lewis & Clark College ♦ Linfield College ♦ Lord Aeck Sargent ♦ Muhlenberg College ♦ Northwestern University ♦ Payette ♦ Quinn Evans Architects ♦ Shepley Bulfinch ♦ Soderstrom Architects ♦ Spillman Farmer Architects ♦ Strada Architecture LLC ♦ SWBR Architects ♦ Syracuse University ♦ UC Berkeley - ETS ♦ UNC Chapel Hill University Library ♦ Union College ♦ University at Albany ♦ University of Arizona Libraries ♦ University of Massachusetts Boston ♦ University of North Carolina at Greensboro ♦ University of Richmond ♦ University of Tennessee, Knoxville ♦ University of Texas at Austin ♦ University of Wisconsin Madison ♦ University of Wisconsin-La Crosse ♦ VMDO Architects ♦ Washington and Lee University ♦

Dr. phil. Felix A. Kronenberg

Asst. Prof. of Modern Languages and Literatures  
Director of the Center for Language Learning

Rhodes College

Bonnie Sanborn

Department of Design and Environmental Analysis

Cornell University

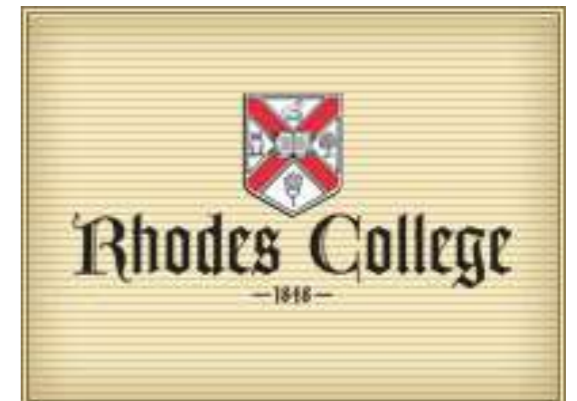

# Spring LSC Webinars

## Learning Spaces Collaboratory

Join the conversation –  
send us your ideas  
about questions to ask  
in shaping learning  
spaces

[pkallsc@pkallsc.org](mailto:pkallsc@pkallsc.org)

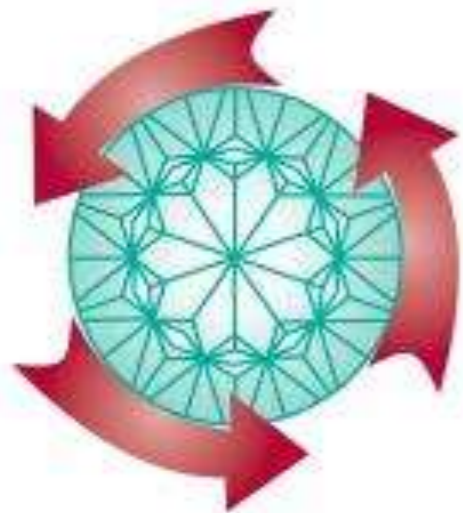

<http://www.pkallsc.org/>

- **Classrooms for Flipped or Blended Learning**  
*April 15, 2015*
- **Implementing an AAU STEM Initiative: Integrating Renewal of How and Where Learning Happens**  
*May 5, 2015*
- **Reframing the Concept of Maker Spaces: Maker Spaces Reinvented**  
*June 10, 2015*