

Linking Planning of Spaces with Institutional Mission & Vision

Meredith College – Planning facilities for Undergraduate Science & Mathematics

Lee Willard – Duke University

Douglas Weldon – Hamilton College

Michael Reagan – Burt Hill

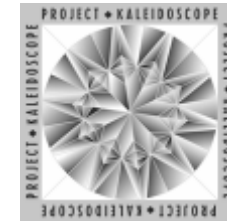

Linking Space Planning with Institutional Mission & Vision

What is the
difference
between mission
& vision?

Mission is who
you are!

Vision is where
you want to go!

Linking Space Planning with Institutional Mission & Vision

Why should
planning be
linked with
mission &
vision?

Common Ground
Common Cause
Provide a Guide

Linking Space Planning with Institutional Mission & Vision

What are the
benefits of
linking planning
with mission &
vision?

Unique Identity
Assist Development

Linking Space Planning with Institutional Mission & Vision

What are some
examples of
linked planning
and mission?

Meredith College

Linking Space Planning with Institutional Mission & Vision

When should
planning be
linked with
mission &
vision?

If you have to ask its
too late

Linking Space Planning with Institutional Mission & Vision

What is the
process for
linking
planning with
mission &
vision?

Hamilton College

Dickinson College



Hiram College



...to maintaining a mentoring community which integrates academic life with the total campus experience..."

University of Scranton



“...community of scholars...dedicated to freedom of inquiry, the pursuit of wisdom, integrity and truth, and the personal growth and development of all ...”



Planning the Hamilton College Science Center Project

Douglas A. Weldon
dweldon@hamilton.edu





Goals of the Project

- Bring all sciences into the same facility to reflect and encourage interdisciplinary activity
- Support student research at all levels
- Provide flexible teaching spaces
- Make science visible to the campus community
- Incorporate technology into teaching spaces
- Provide education regarding sustainable design



Sequence of Decisions

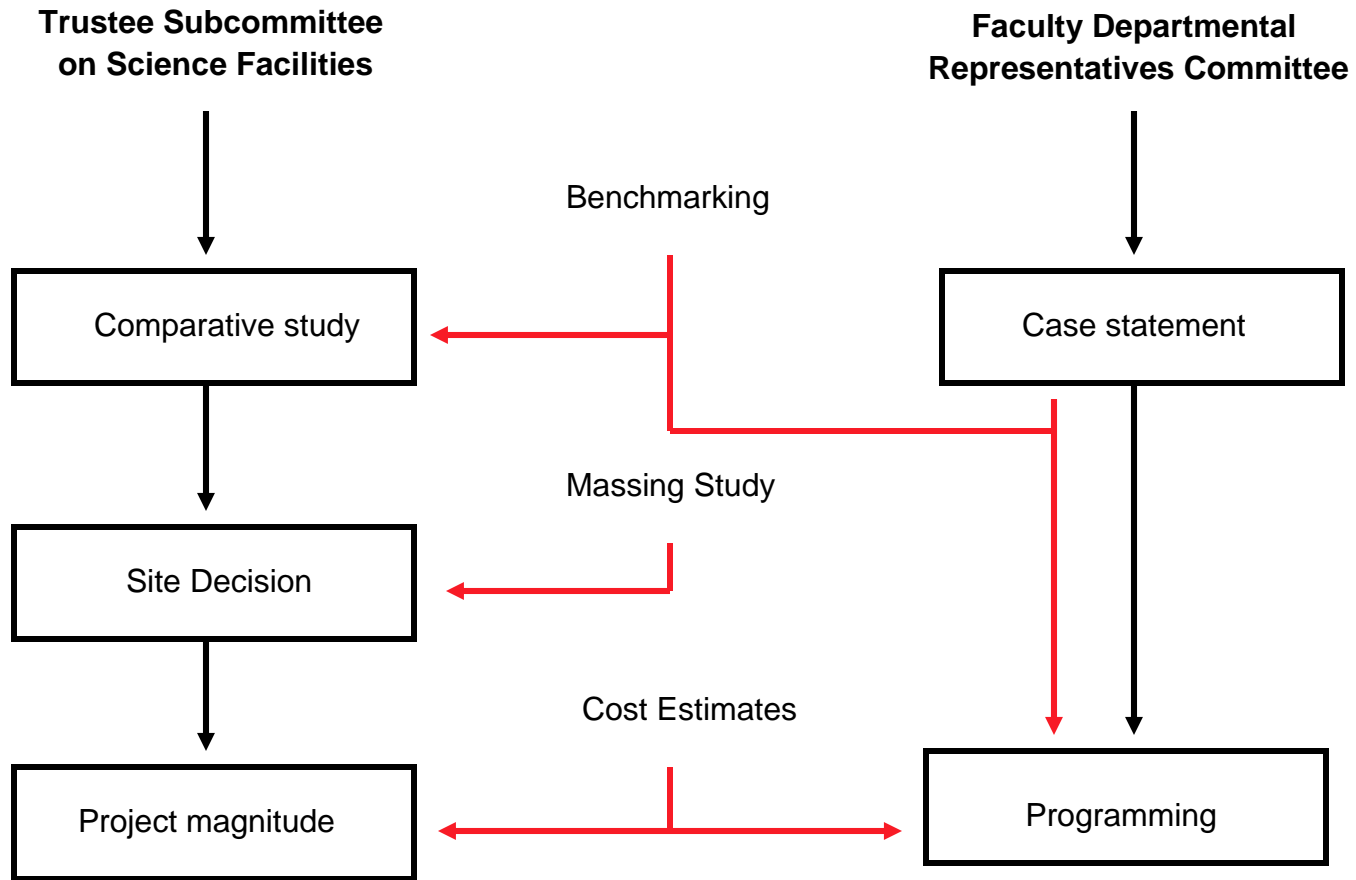

Where to Site the Science Center?

(Dober, Lidsky, Craig & Associates)

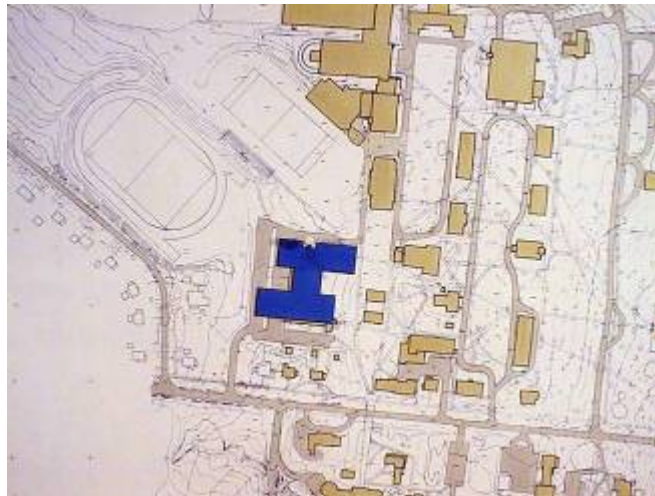
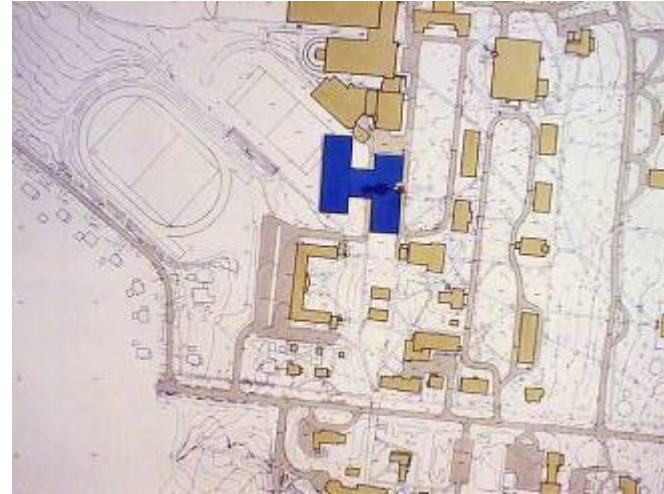
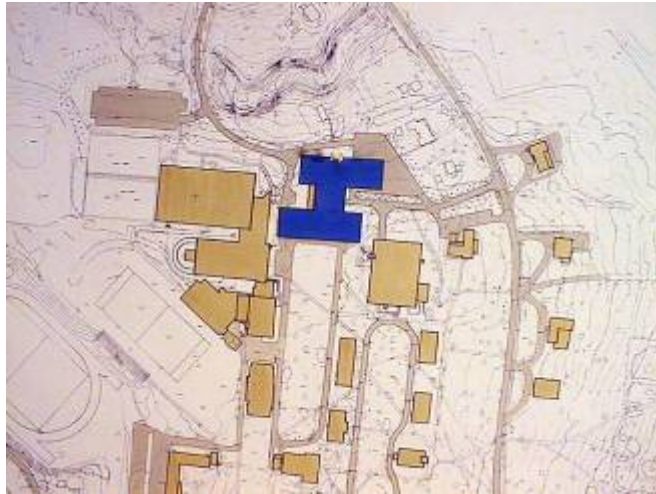

Massing Study

(Ewing Cole Cherry Brott)

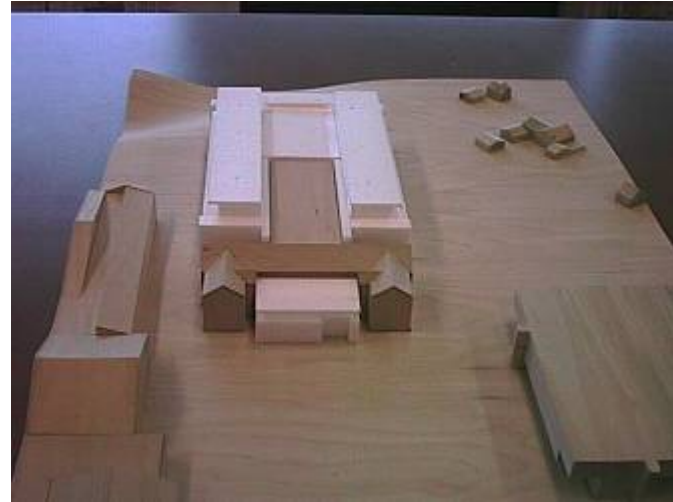



Issues for the Faculty Representative Committee

- Background:
 - Project Kaleidoscope workshops
 - Benchmarking information
 - Visits to 30 institutions
 - Faculty discussions
 - Case statement
- Definition of departmental needs
- Definition of interdepartmental needs
- Definition of departmental adjacencies
- Decision regarding what departments to include
 - (Archaeology, Mathematics and Computer Science?)
- Decision regarding a science library
- Incorporation of public spaces into the program



Committees

- *Architect Selection Committee*
- *Building Committee*
- *Departmental Representatives*
- *Classroom Committee*
- *“Green Team”*